

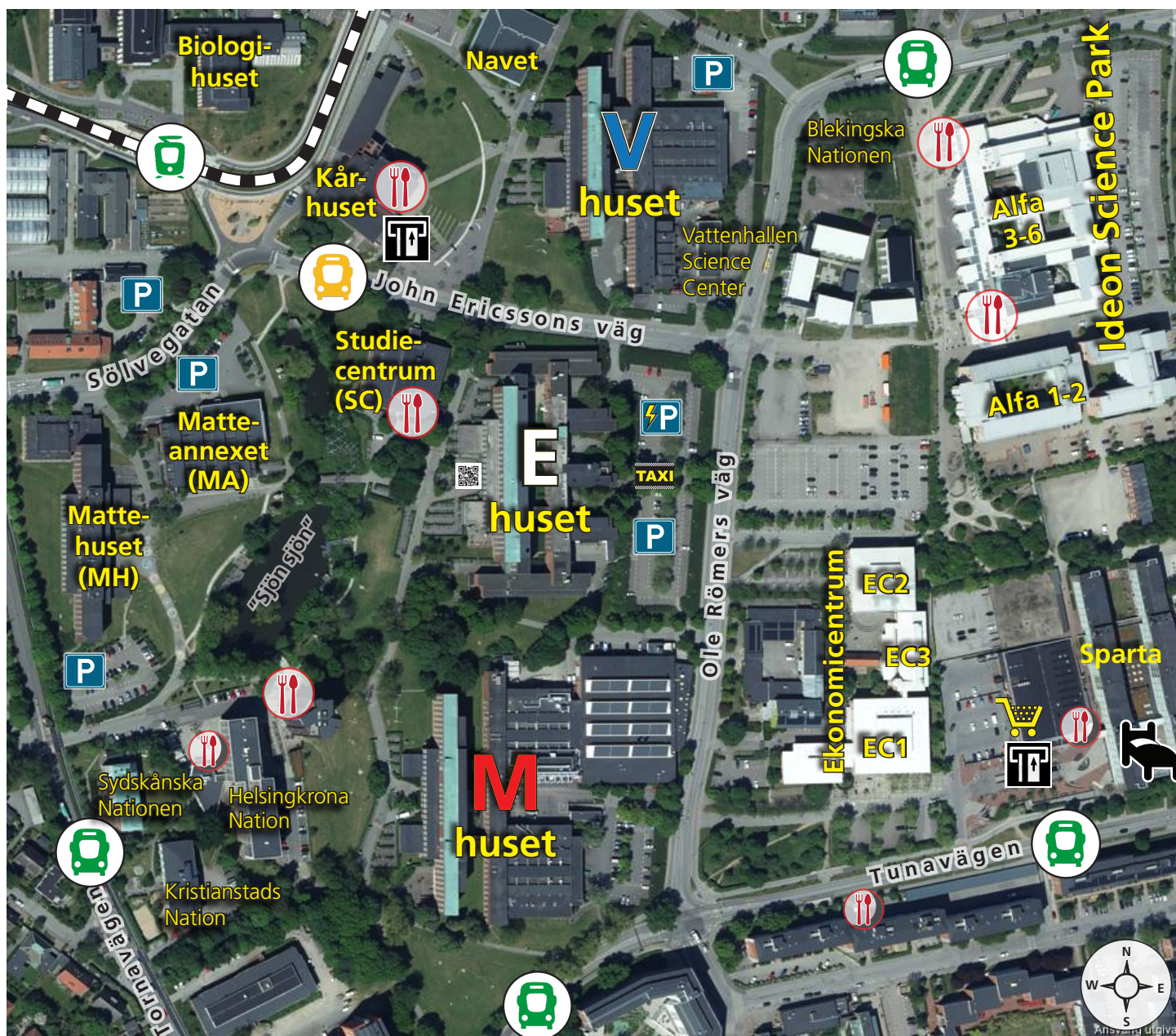

The E-building and its surroundings:



 Restaurants (open for lunch)

 Restaurants that are also open during evenings

 ATM

 Supermarket (ICA Tuna)

 Lund University Guest House (Sparta)

 Paid 24h parking. Parking meter exists that accepts various cards as well as parking apps.

Ticket for longer stay may be purchased

 Public transport; tram () , regional buses () and city buses ()

 Address is: Ole Römers väg 3, 223 63 Lund



55.71102°N
13.21009° E

Inside the E-building:

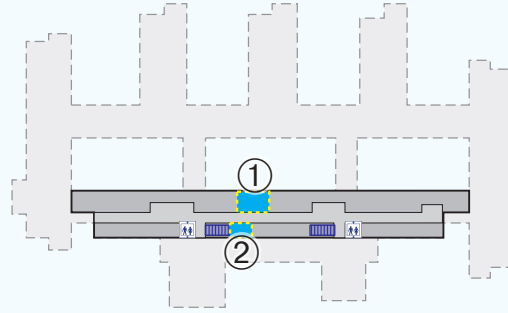
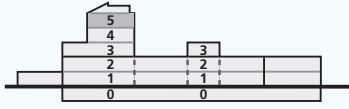
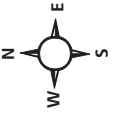

Fifth floor (Student Service, LTH):

- ① Seminar room "Everest", 5129
- ② Seminar room "K2", 5169

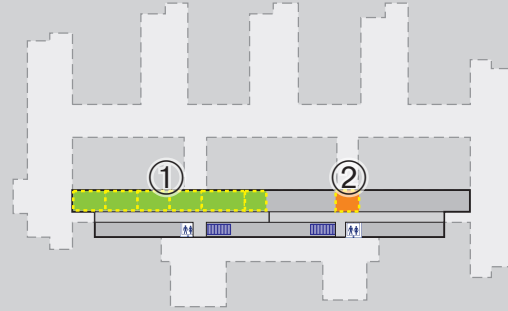
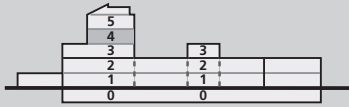

Fourth floor:

- ① EIT labs, 4115-24
- ② LUCAS room, 4130

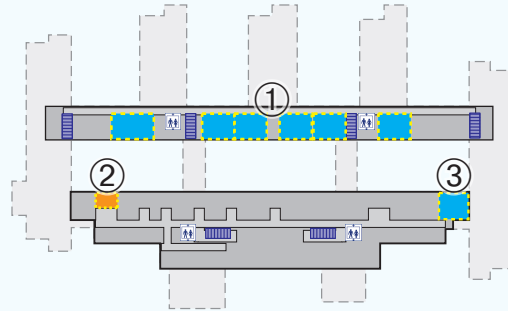
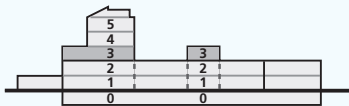

Third floor:

- ① Seminar rooms "33-salarna" in the east part of the building
- ② Conference room 3114C
- ③ Seminar room 3139

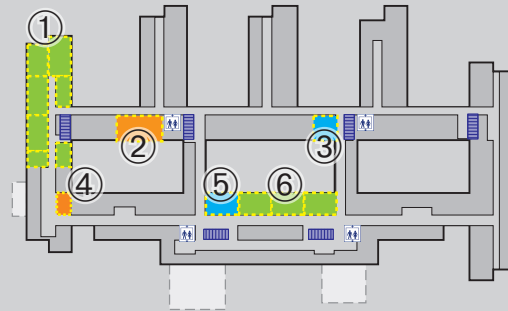
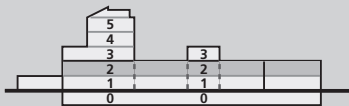

Second floor:

- ① Lab "Siberia" (24xx-labs)
- ② "the Orangerie", 2311
- ③ Seminar room 2349 ("the kitchen")
- ④ The "Glass cage" 2405
- ⑤ Seminar room 2116
- ⑥ Computer labs alfa, beta, gamma

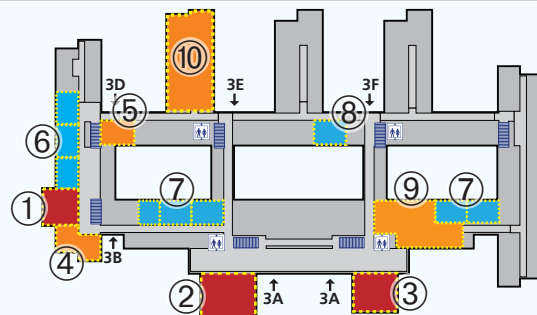
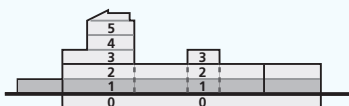

First floor:

- Auditorium: ① 1406, ② E:A, ③ E:B
- ④ Library
- ⑤ Meeting room 1426
- Seminar room: ⑥ 14xx, ⑦ 11xx, ⑧ 1328
- ⑨ Café
- ⑩ L-Tek

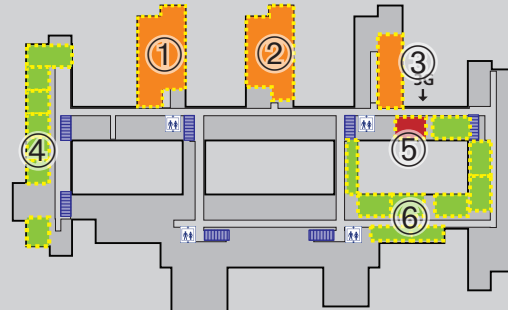
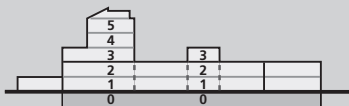

Basement:

- ① Edekvata, ② Idéet
- ③ Beadle office, goods receipt, print shop
- ④ Computer labs "planet rooms"
- ⑤ Auditorium E:C
- ⑥ Computer labs "animal rooms"