

E-husets omgivning:

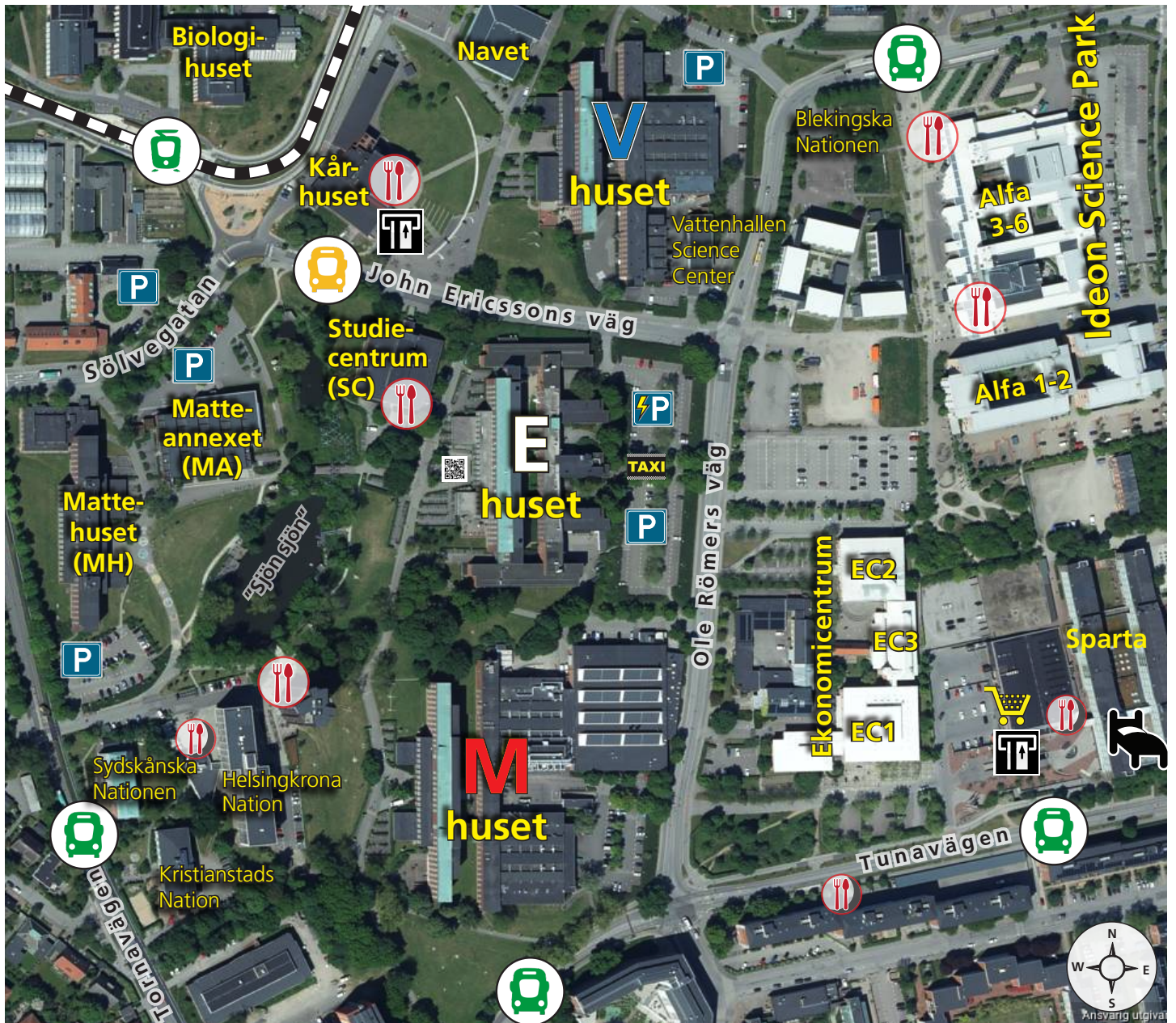

 Restauranger (lunchöppna)

 Restauranger som även har öppet på kvällen

 Uttagsautomat

 Snabbköp (ICA Tuna)

 Lund University Guest House (Sparta)

 Parkering (kostar dygnet runt). Betalautomater finns som tar olika slags betalkort eller parkeringstjänster (Parkster). Terminsbiljett finns

 Kollektivtrafik stannar i närheten; spårvagn () , regionbussar () och stadsbussar ()

 Adressen är: Ole Römers väg 3, 223 63 Lund



55,71102°N
13,21009° Ö

E-huset inuti:

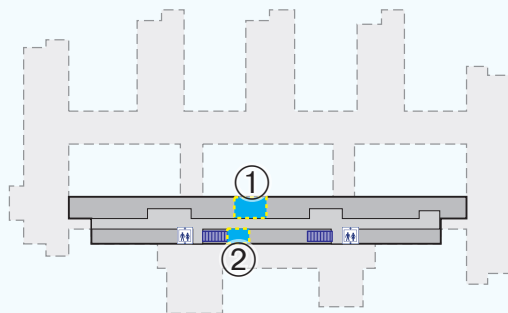
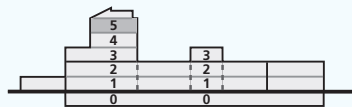
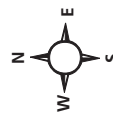

Våning 5 (Studentservice, LTH):

- ① Seminarierum "Everest", 5129
- ② Seminarierum "K2", 5169

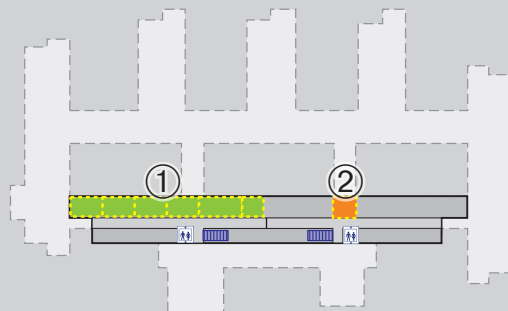
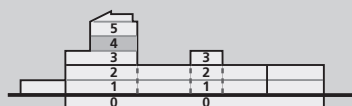

Våning 4:

- ① Labblokaler EIT, 4115-24
- ② LUCAS-rummet 4130

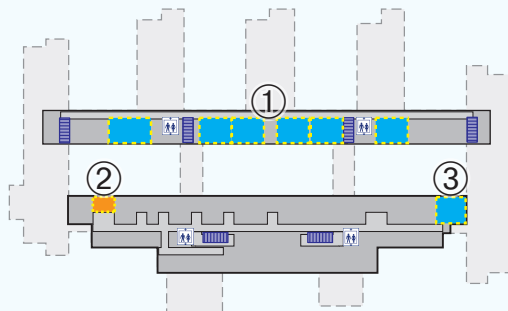
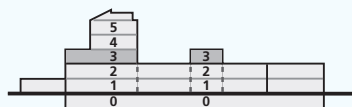

Våning 3:

- ① Seminarierum "33-salarna" i östra huskroppen ("låghusdelen")
- ② Sammanträdesrum 3114C
- ③ Seminarierum 3139

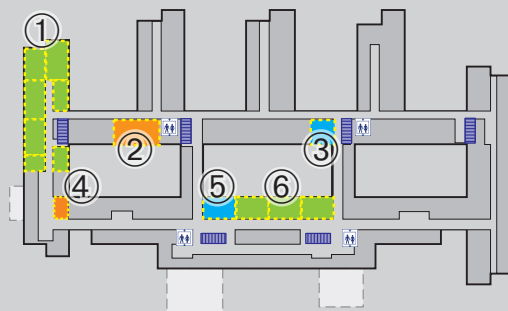
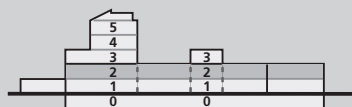

Våning 2:

- ① Lab "Sibirien" (24xx-salarna)
- ② "Orangeriet", 2311
- ③ Seminarierum 2349 ("köket")
- ④ Sammantr.rum "Glasburen" 2405
- ⑤ Seminarierum 2116
- ⑥ Datorrum alfa, beta, gamma

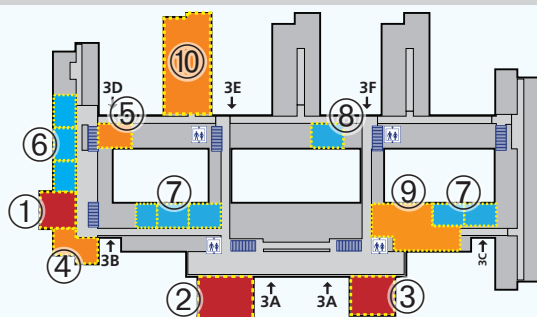
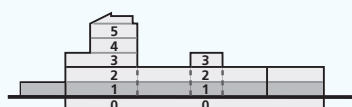

Våning 1:

- Hörsalar: ① 1406, ② E:A, ③ E:B
- ④ Bibliotek
 - ⑤ Sammanträdesrum 1426
- Seminarierum: ⑥ 14xx, ⑦ 11xx, ⑧ 1328
- ⑨ Café
 - ⑩ L-Tek

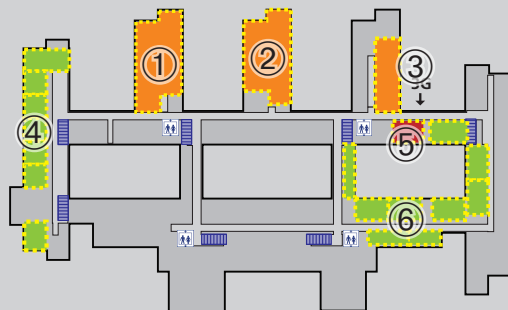
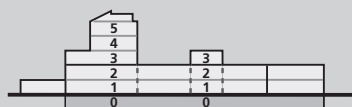

Våning 0 (källaren):

- ① Edekvata
- ② Idéet
- ③ Vaktmästeri, godsmottagn., Tryckeri
- ④ Datorrum "planetrummen"
- ⑤ Hörsal E:C
- ⑥ Datorrum "djurrummen"